



REVO Block Professional vacuum units are the best vacuum cleaners for professional use on central vacuum unit sector. Their high quality construction is combined with a performance electronic management of latest generation, used to simplify installation and use: everything can be managed by the new touch screen display.

■ INSTALLATION AREA

Revo Block Professional vacuum units can be used in buildings with the following features:

- Surfaces up to 1800 m²
- Suitable for 3 users maximum
- Pipe network according to the number of users
- Supply: from 220/240 Vac single-phase to 400 V three-phase
- Continuous use
- External air exhaust



■ Revo Block Professional SELECTION TABLE

MODEL	Recommended surface	ARTICLE	Supply V ac	Max. number of users
Revo Block Professional 700 Plus	700 m ²	3213.2B	400	2
Revo Block Professional 1000	1000 m ²	3203.3B	220/240	2
Revo Block Professional 1200	1200 m ²	3203.4B	400	2
Revo Block Professional 1500	1500 m ²	3203.5B	400	2
Revo Block Professional 1800	1800 m ²	3203.6B	400	3

■ SYNTHETIC CHARACTERISTICS



Maintenance computer



IP protection degree



Optional automatic filter cleaning



Isolation class 1



Energy saving vacuum unit



Max number of users: 3



CE marking

REVO BLOCK PROFESSIONAL

■ MAIN FEATURES OF THE PRODUCT

1 - New touchscreen interface

The Revo Block Professional vacuum units of latest generation have a new touchscreen display that makes their use easier.

The touchscreen display is an easy interface for all users:

- For the installer, that can find all set-ups to manage the working of the vacuum unit;
- For the final user, that can check the system conditions in every moment, with real time messages about required maintenance and instructions to execute them.

Thanks to the graphic display, **all maintenance operations are supported by images for immediate understanding**, supporting the service staff without the need of the instruction manual.

For the installer, the graphic display means an extra value in these circumstances:

- During the first installation, because a special training is not required, but just follow the wizard;
- During the next maintenance operations it is possible to control all the working parameters on the display, in order to find immediately the correct operation.

The display is nothing but the interface of a real computer set up that rules the vacuum unit and optimizes its performances, stating:

- The depression on the system, with the possibility to modify the vacuum power directly from the display
- The level of the dust container
- The filter efficiency
- The need for scheduled maintenance, showing the phone number that the installer has entered during first installation

Additional functions can be managed from the touch screen:

- **Autocleaner maintenance (if present);**
- **Set up of vacuum interruption, in case of warning and/or alarm.**
- **Test function**
- **Alarms list achieve**
- **Electrical consumptions of the vacuum unit**
- **Extraordinary maintenance activities list**



Screen examples:



Main screen

It is possible to verify if the vacuum unit is On, the central system depression, all the others control screens.



Filter control

Filter efficiency, thanks to the colored status bar, easy to understand.



Dust bin emptying

Instructions for dust bin emptying: when the vacuum unit advises that the bin must be emptied, an animation sequence shows how to perform the operation, helping even the inexperienced user.



Vacuum unit info

Screen with info about the unit, with all working parameters.

2 -Consumption optimization control



The commitment of Sistem Air to reduce consumption of its central vacuum units continues with the new Revo Block Professional line: compared to the previous models, **new blowing motors** have been adopted and they have a better energy efficiency class (IE2 class), able to offer the same vacuum power, with lower consumptions.

The electronic motor maintenance, that optimizes performances and prevents any absorption peaks, can process the data that have been transmitted from a **temperature sensor** installed on the motor, to act promptly on the operating parameters and avoid possible malfunctions.

These features grant a **greater reliability**.

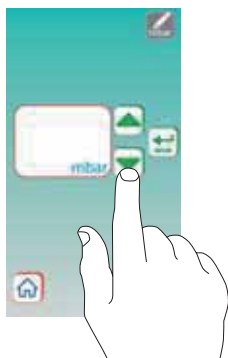
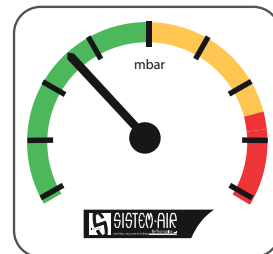

REVO Block Professional units **have a continuous control system of vacuum power**, that allows to maintain it constant even with different use conditions (for example an additional user that starts working or a brush change).

Then it is possible to set up the depression required: set up is made with the touchscreen display in a quick and easy way.

3 - Simplification

Revo Block vacuum units installation is really easy, thanks to the new electronic components, with easy connections and without the possibility of making mistakes. Even the management of more users at the same time doesn't need additional panels or resistive dividers connected to the vacuum inlets: the automatic control system of performances detects the change and acts on the motor so as to compensate the vacuum power and ensure its proper dispensing.

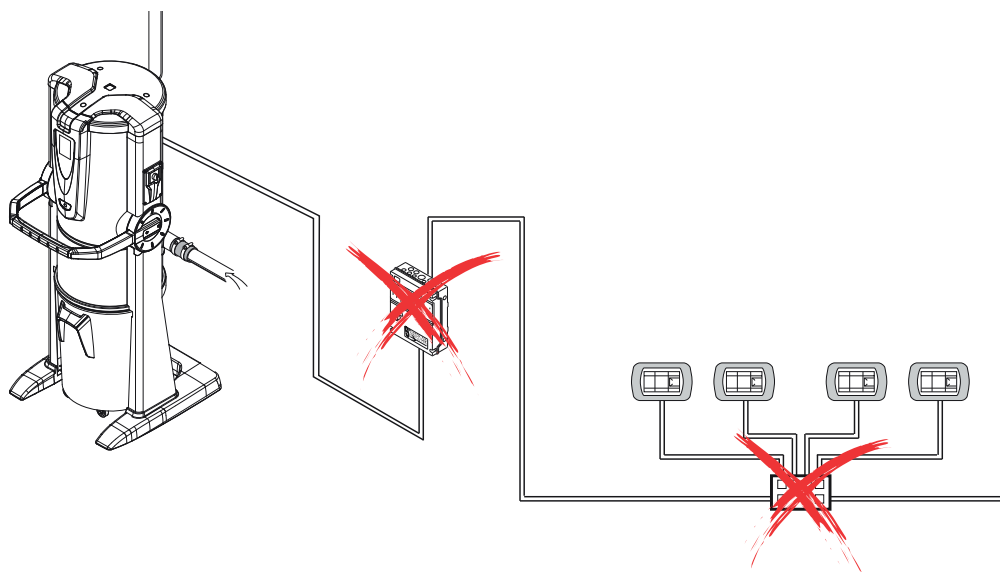

REVO BLOCK PROFESSIONAL

4 - Automatic filter cleaning

All Revo Block vacuum units are designed for the installation of the **Autocleaner system**: a reversed **compressed air spray** crosses the filter and the dust on the filter surface or between its folds, can drop inside the dustbin.

Autocleaner can be programmed on one's choice and this device can be installed after the vacuum unit installation. All Revo Block vacuum units have the Autocleaner arrangement, that consist of pneumatic connections, electrical connections and software for maintenance managing, that offers standard or personalized set up.

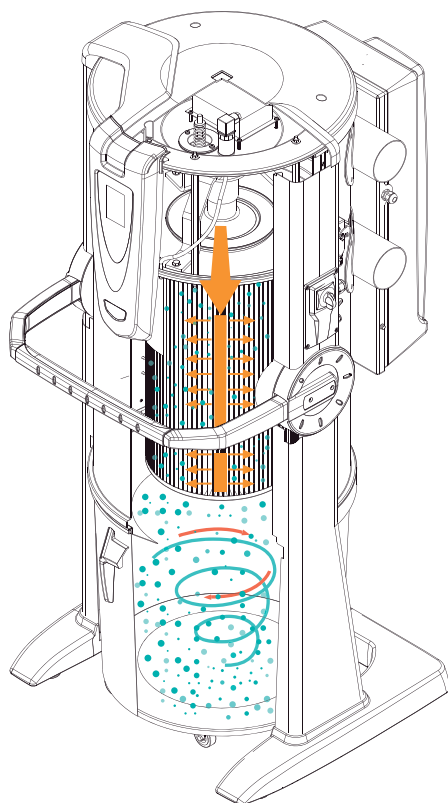

5 - Possibility of remote viewing of the status of the suction unit through the MASTER CONTROL system (optional - see page 62)

Master control is the innovative communication system designed by Sistem Air for remote monitoring of industrial and professional vacuum units. The system consists of two elements:

- **Communication interface**, to be installed on each vacuum unit (compact machine or dust separator) and to be connected to the local network local using a seria cable;
- **Control software**, to be installed on a PC connected to the same local network to which the vacuum units are connected. With the same PC it is possible to check all the machines connected to the network.

The software allows immediate control of them, displaying the status of each machine and the necessary maintenance, with the possibility to consult the procedure on how to carry out maintenance both in PDF and video format.

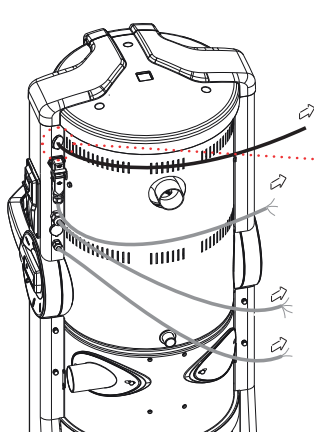

**MASTER
CONTROL**



Revo Block Professional section

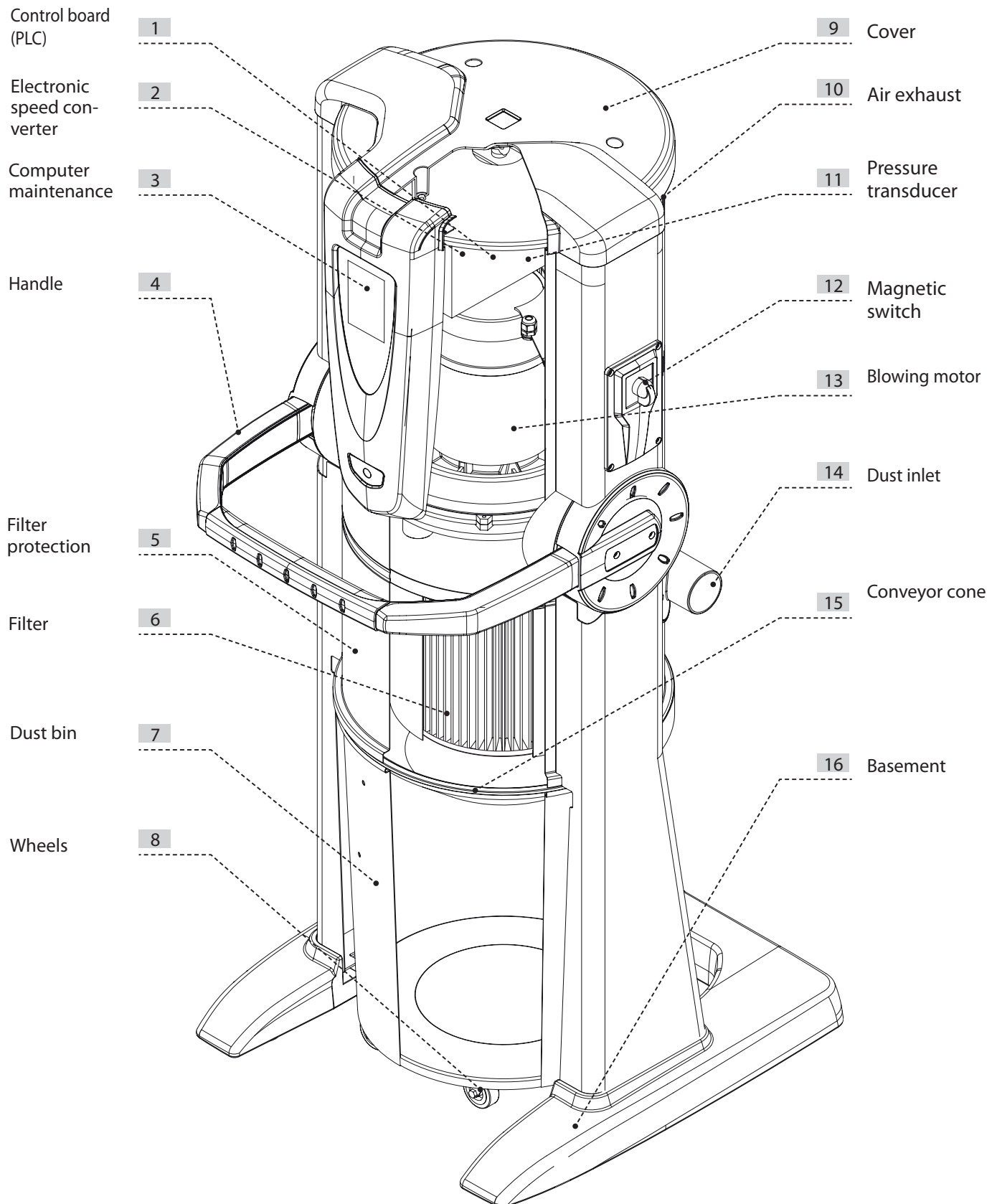

REVO BLOCK PROFESSIONAL

Measurements and technical data

REVO Block Professional line can be installed for professional and semi-professional uses, with a maximum of three users at the same time. The model can be chosen according to the total surface to clean and the number of users required, in order to grant the vacuum power needed.

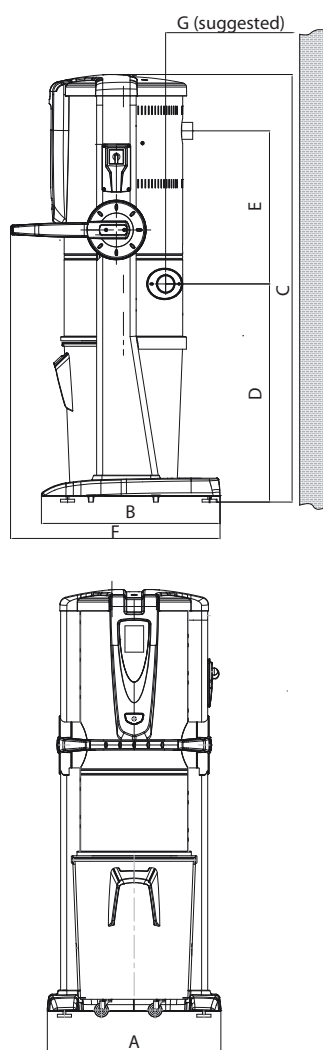

Revo Block Professional						
Model Article		Revo Block 700 Plus	Revo Block 1000	Revo Block 1200	Revo Block 1500	Revo Block 1800
		3213.2B	3203.3B	3203.4B	3203.5B	3203.6B
Maintenance computer		YES	YES	YES	YES	YES
Vacuum inlet	Ø mm	63 ^(*)	63 ^(*)	63 ^(*)	63 ^(*)	80
Air discharge	Ø mm	63	63	63	63	80
IP protection degree	IP	20	20	20	20	20
Supply	V ac	400	220/240	400	400	400
Frequency	Hz	50/60	50/60	50/60	50/60	50/60
Motor power	kW	3	2,2	2,2	4	4
Absorption	A	6,3	7,9	4,6	8,1	8,1
Vacuum inlets supply	V dc	12	12	12	12	12
Speed electronic converter		NO	YES	YES	YES	YES
Maximum air flow	m³/h	400	366	366	471	570
Filtering surface	cm²	17800	17800	17800	17800	17800
Dust bin capacity	l	106	106	106	106	106
Air discharge		YES	YES	YES	YES	YES
Air discharge silencer		YES	YES	YES	YES	YES
Weight	kg	95	95	95	105	115
Measurements A	mm	750	750	750	750	750
Measurements B	mm	633	633	633	633	633
Measurements C	mm	1616	1616	1616	1616	1616
Measurements D	mm	773	773	773	773	773
Measurements E	mm	642	642	642	642	642
Measurements F	mm	750	750	750	750	750
Measurements G	mm	600	600	600	600	600
Noise	dB(A)	60÷80				

N. B: Nominal noise values. Values may vary according to environment and manner in which the unit is installed.

*these models are supplied with a sleeve 63/80 to connect the vacuum unit to the pipe network.

APPROVALS

CE CE marking

IP protection degree

IP 20

Electrical insulation
CLASS I



Revo Block Professional Line

Device in compliance with the following standards:

EC DIRECTIVES

- 2006/42/CE
- 2006/95/CE
- 2004/108/CE

APPLIED HARMONISED STANDARDS

- EN 60335-1 : 2012
- EN 60335-2-2 : 2010
- EN 61000-3-2 : 2006 + A2 : 2009

- EN 61000-3-3 : 2008

- EN 55014-1 : 2006 + A1 : 2009

- EN 55014-2 : 1997 + A2 : 2008

- EN 62233: 2008

ROHS DIRECTIVE 2002/95

COMPLIANCE TO REACH DIRECTIVES.

N.B. installation must be carried out in strict compliance with current regulations

TECHNICAL FEATURES

REVO Block Professional vacuum units are designed and produced in conformity with all current regulations and European directives, whilst taking into account functionality, power and capacity.

Main technical characteristics can be listed as follows:

- Metal cylindrical frame painted with epoxy powder
- Base coated with anti-shock material to protect the vacuum unit.
- Metal dustbin with wheels (capacity 106 litres)
- Bag with bag stretchers inside the dustbin, to dispose of dust quickly and hygienically.
- Possible connection to the piping from the right or from the left side, independently of each other.
- Single-phase and three-phase power supply
- Side-channel motor-pump group with light alloy case, high-performance and maintenance-free; professional motor with CE marking, IP 55 protection degree, F IEC 2 class, with integrated silencer.
- Thermal protector PTO
- Mechanical breaker valve
- Automatic adjustment of vacuum power (inverter)
- Vacuum power customizable set up
- Maintenance computer with touchscreen interface
- Pressure transducer for vacuum performance reading
- Class M polyester filter, water washable.
- Filter protection for a reduced maintenance.
- Vacuum inlets supply: 12 V.
- Complete with silencer and sleeves for pipe network connection
- Suitable for all Sistem Air cleaning accessories
- Possibility to combine, even after installation, the automatic filter cleaning system Autocleaner

PERFORMANCE GRAPHS

Depression mbar Revo Block 700 Plus

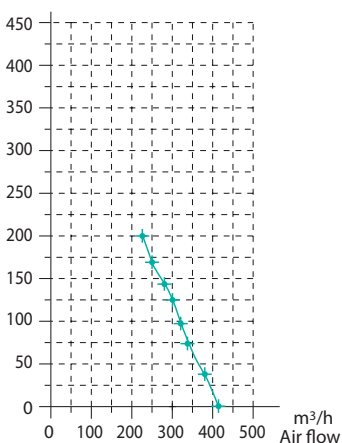

Depression mbar Revo Block 1000 Revo Block 1200

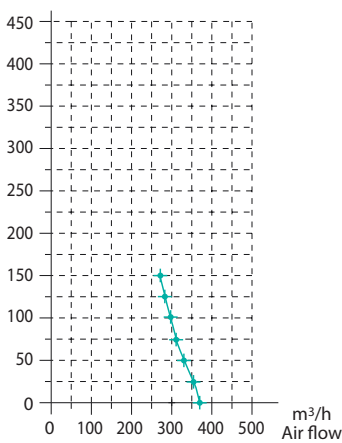

Depression mbar Revo Block 1500

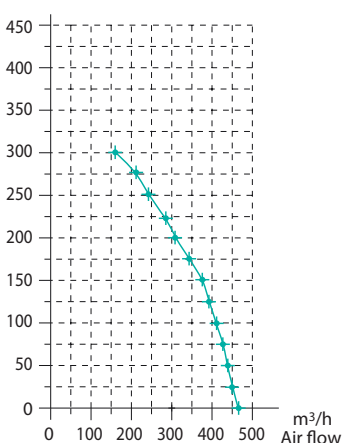

Depression mbar Revo Block 1800

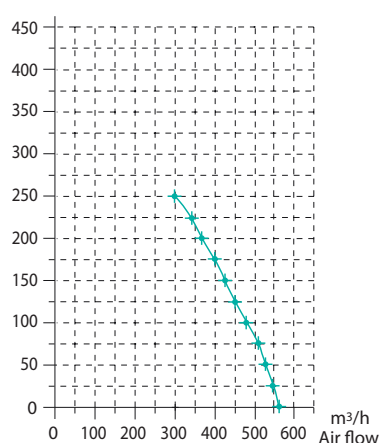

REVO BLOCK PROFESSIONAL

INSTALLATION HINTS

Vacuum units are equipped with an air discharge connection, in order to expel dust particles that the filter cannot hold outside. They can be placed in soundproofed technical rooms or utility rooms (for example garages, basements, etc...) to protect the other rooms from noise and to keep them protected from bad weather, humidity and temperature leaps. Keep away from heat sources, such as stoves or radiators. (N.B.: IP protection degree 20).

In the design stage, we recommend identification of the best location for the central unit with respect to the system, leaving a reasonable space for installation, use, maintenance, a proper air exchange around the unit and passive acoustic requirements of the building.

If the system is installed in a building with several floors, we suggest placing the vacuum unit on the bottom floor.

In case of exposed pipes, to avoid the sediment of dusts on the walls close to the pipes caused by static charges, we recommend to make the pipe network with metal pipes, connected to the ground.

INSTALLING THE CENTRAL UNIT

The vacuum unit does not require special anchoring. However, it is important to check that the area for installation has the following minimum requirements, in order to be correctly and securely positioned.

- a perfectly flat, horizontal and solid surface, without cracks.
- a vibration free surface. Furthermore it is essential that there are no disconnections that could make the central unit instable.

PIPE CONNECTION

Connections to pipe network and to air expulsion can be made on the left or on the right side of the vacuum unit.

WARNING: if the discharge pipe is longer than 5 meters it is necessary to install a bigger diameter in order to reach the optimal conditions for air expulsion.

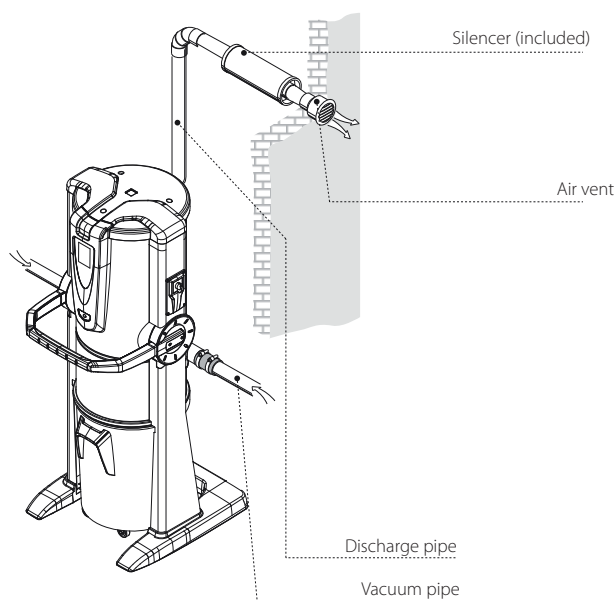

EASY BIN EMPTYING

Revo Block Professional vacuum units have a dust container with an easy opening system and a soft touch handle coated in shockproof material.

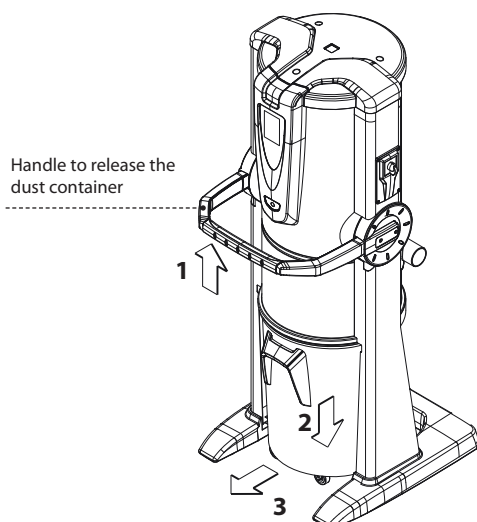

DUST CONTAINER WITH WHEELS

Thanks to its wheels, the dust container can be moved easily.

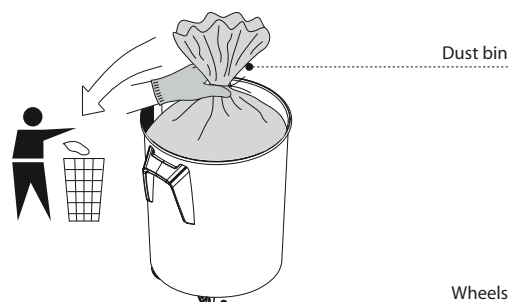

ELECTRICAL CONNECTION

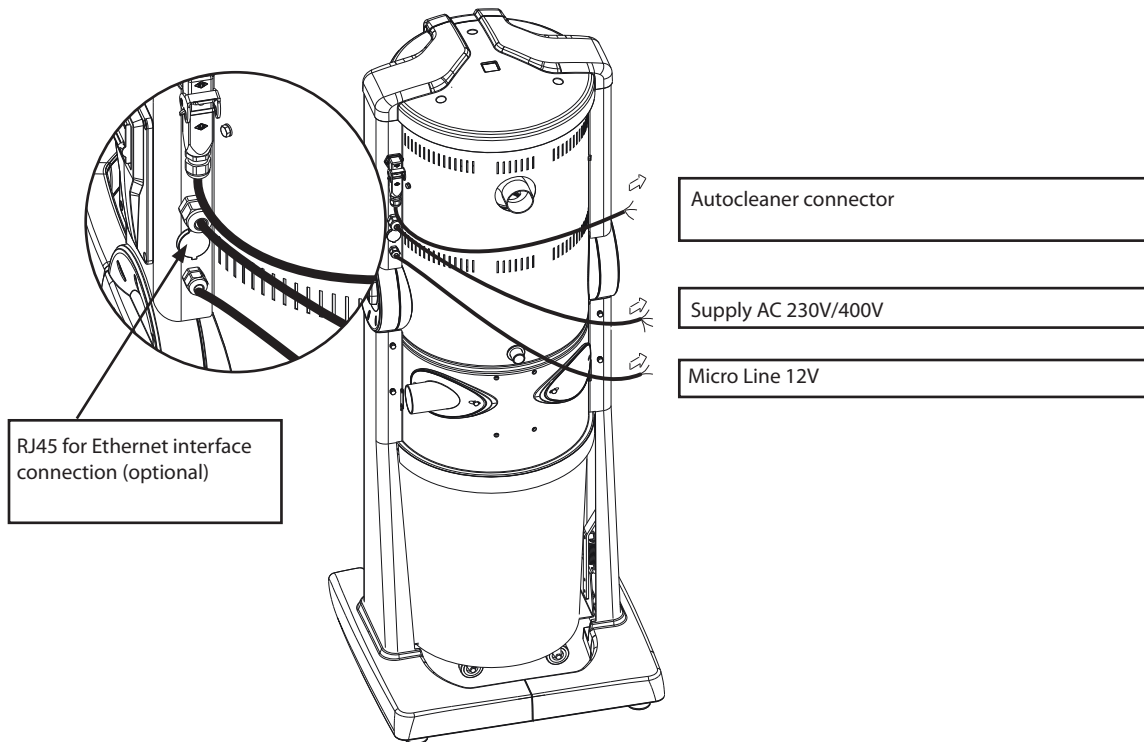

MAINTENANCE AND ASSISTANCE

Programmed routine maintenance of central vacuum units must be done according to the instructions in the technical manual and on the display.

In particular, these routine maintenance cycles concern filter cleaning, emptying of the dust-bin, bag substitution, checking that the electric motor is working correctly, possible air discharge and obstruction checking.

All extraordinary maintenance operations must be carried out by qualified and/or authorised staff.

For more details, technical information and assistance please visit our web site sistemair.com

revo block professional

The Revo Block line represents the most advanced expression of central vacuum units for professional use, with an advanced energy saving system which, thanks to the touch screen interface, results extremely simple to manage even for the end user.

